

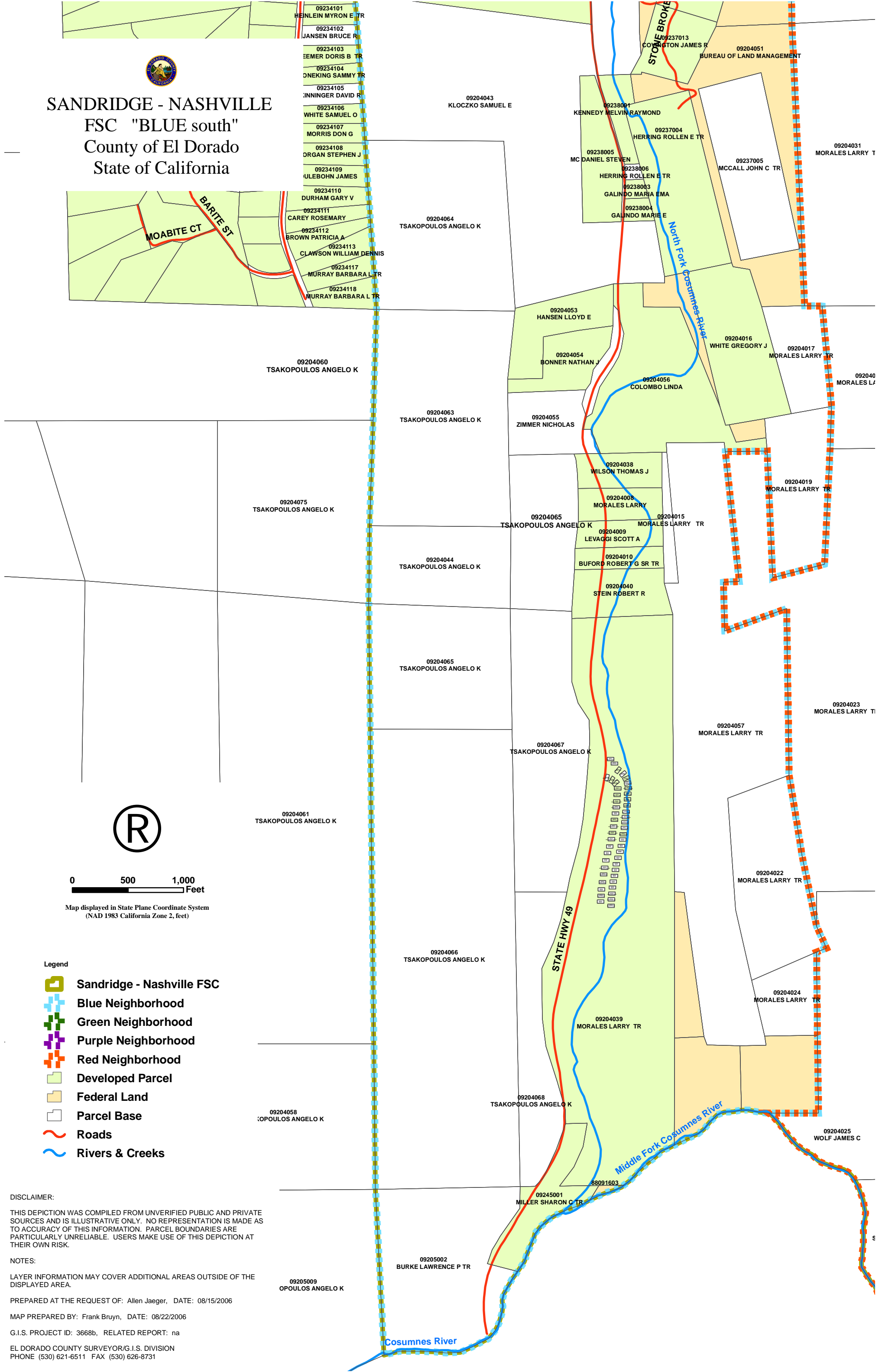

SANDRIDGE - NASHVILLE
FSC "BLUE south"
 County of El Dorado
 State of California

- 09234101 HEINLEIN MYRON E TR
- 09234102 JANSEN BRUCE R
- 09234103 EEMER DORIS B TR
- 09234104 ONEKING SAMMY TR
- 09234105 INNINGER DAVID R
- 09234106 WHITE SAMUEL O
- 09234107 MORRIS DON G
- 09234108 ORGAN STEPHEN J
- 09234109 ULEBOHN JAMES
- 09234110 DURHAM GARY V
- 09234111 CAREY ROSEMARY
- 09234112 BROWN PATRICIA A
- 09234113 CLAWSON WILLIAM DENNIS
- 09234117 MURRAY BARBARA L TR
- 09234118 MURRAY BARBARA L TR

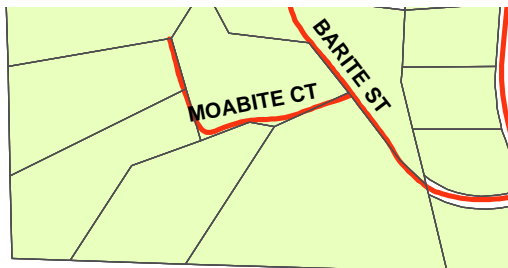

0 500 1,000 Feet

Map displayed in State Plane Coordinate System
 (NAD 1983 California Zone 2, feet)

- Legend**
- Sandridge - Nashville FSC
 - Blue Neighborhood
 - Green Neighborhood
 - Purple Neighborhood
 - Red Neighborhood
 - Developed Parcel
 - Federal Land
 - Parcel Base
 - Roads
 - Rivers & Creeks

DISCLAIMER:
 THIS DEPICTION WAS COMPILED FROM UNVERIFIED PUBLIC AND PRIVATE SOURCES AND IS ILLUSTRATIVE ONLY. NO REPRESENTATION IS MADE AS TO ACCURACY OF THIS INFORMATION. PARCEL BOUNDARIES ARE PARTICULARLY UNRELIABLE. USERS MAKE USE OF THIS DEPICTION AT THEIR OWN RISK.

NOTES:
 LAYER INFORMATION MAY COVER ADDITIONAL AREAS OUTSIDE OF THE DISPLAYED AREA.

PREPARED AT THE REQUEST OF: Allen Jaeger, DATE: 08/15/2006

MAP PREPARED BY: Frank Bruyn, DATE: 08/22/2006

G.I.S. PROJECT ID: 3668b, RELATED REPORT: na

EL DORADO COUNTY SURVEYOR/G.I.S. DIVISION
 PHONE (530) 621-6511 FAX (530) 626-8731